

# Traffic Signalization



**EVELUX Traffic Safety Systems Trd. Co.**

**Head Office**

Perpa Tic. Mer. B Blok 5. Kat No: 473 Okmeydanı Şişli 34384 ISTANBUL/TURKEY  
Tel. +90 212 210 07 92 - info@eveluxtech.com

**Factory**

(KOS) Kırım Cd. Sarı Çiçek Sk. No: 3 Selçuklu 42100 KONYA/TURKEY  
Tel. +90 332 248 10 73 - Fax: +90 332 251 81 65  
www.eveluxtech.com

EVELUX is a division of YUKSELEN GROUP - 42100 KONYA / TURKEY

Export Catalogue - 2014/2015



## Specifications of housing

Material: PC

Diameters: 300, 200 and 100 mm, Aspects 1, 2, 3 as standard

Optics: In accordance with EN dimension

Mounting: Mounting on 50-75 mm pole by polycarbonate brackets

Housing Colours: Black, Light grey, Yellow.

Norm: TS EN 12368

CE marking: TS EN 12368 Annex ZA

## Dimension

Diameter (mm)	No. of Aspects	w	h	d (mm)
300	1	380	345	160
300	2	380	690	160
300	3	380	1035	160
200	1	280	260	130
200	2	280	520	130
200	3	280	780	130
100	1	155	400	90

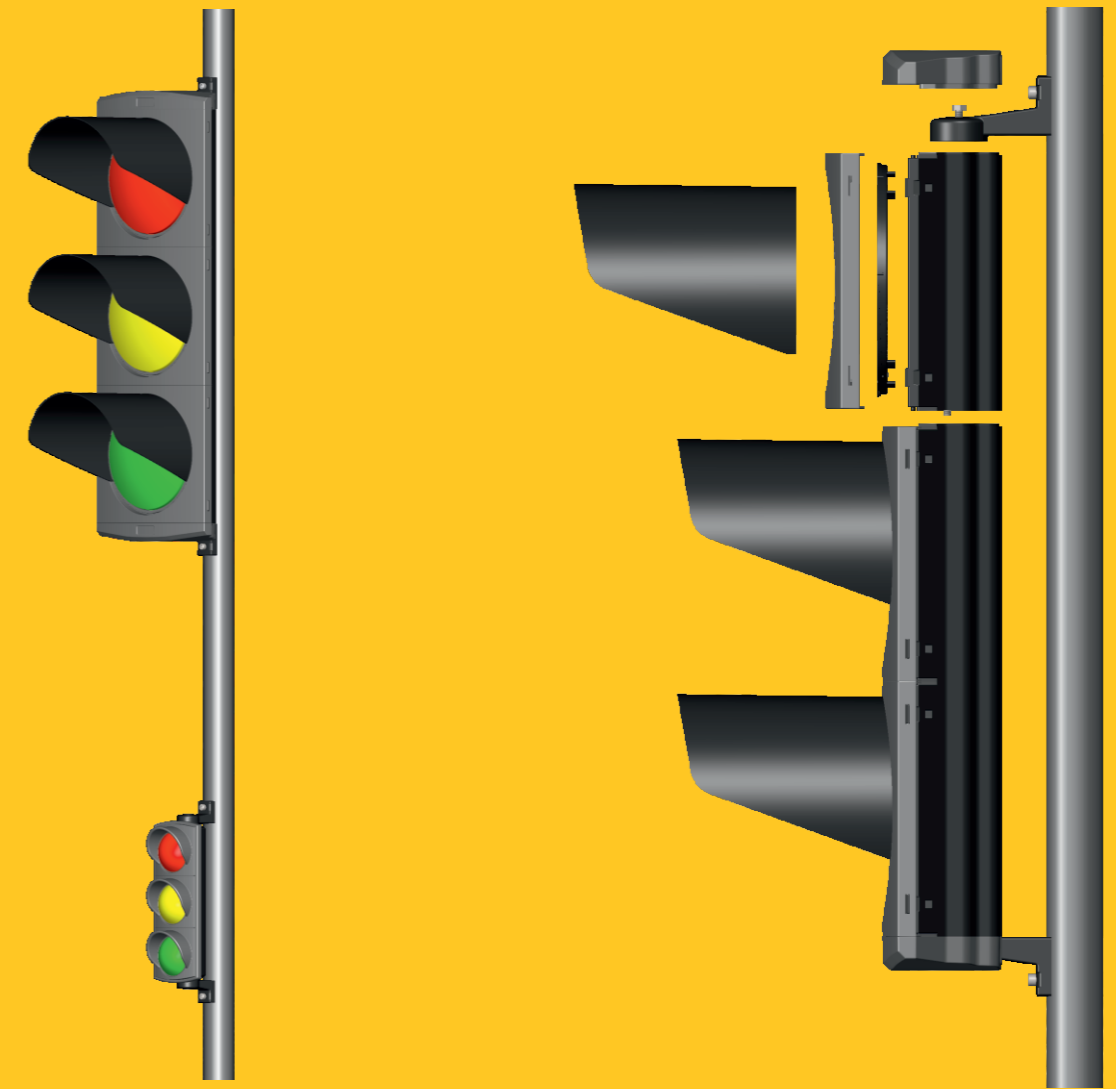
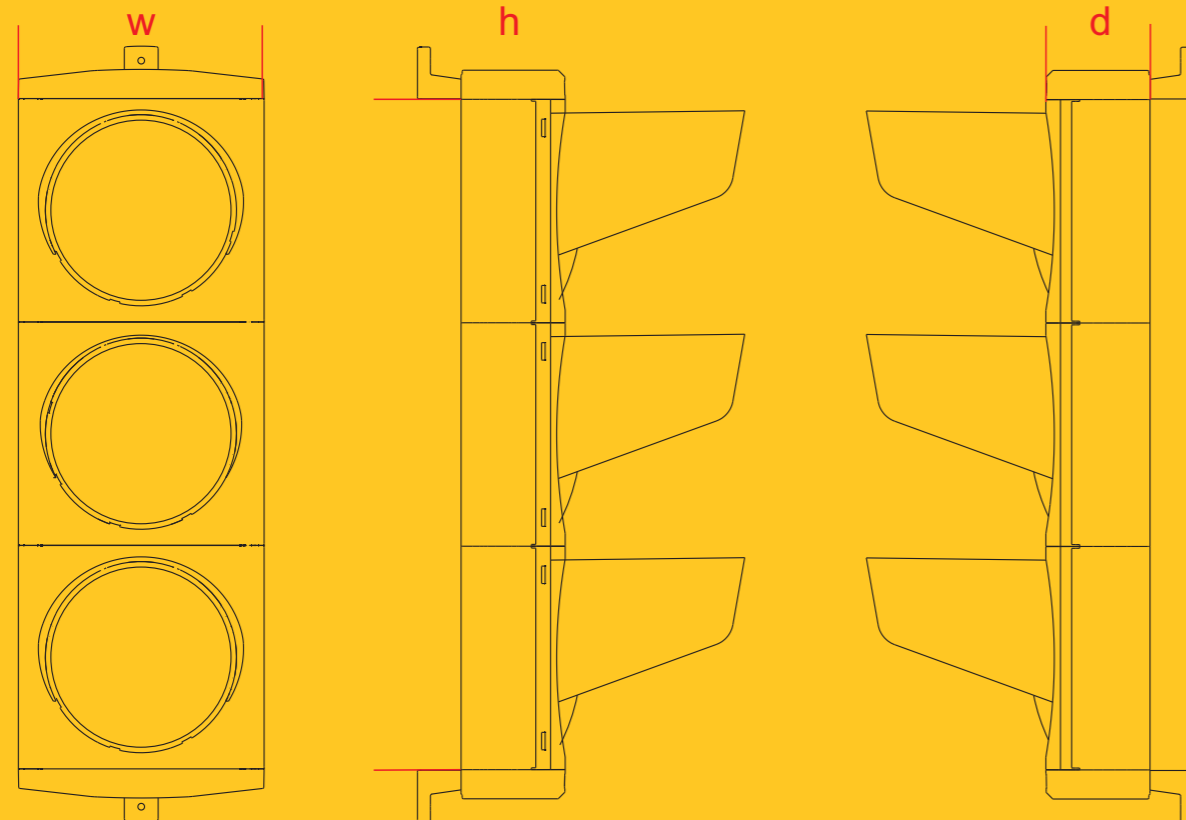

## 300 mm Signalization Parts

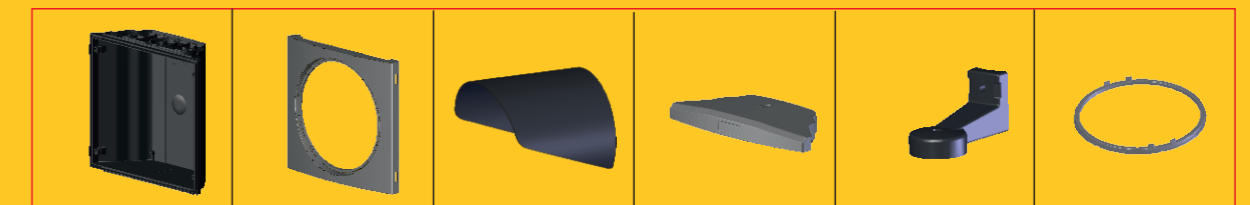

Code 3010 3012 3014 3016 3018 3020

## 200 mm Signalization Parts

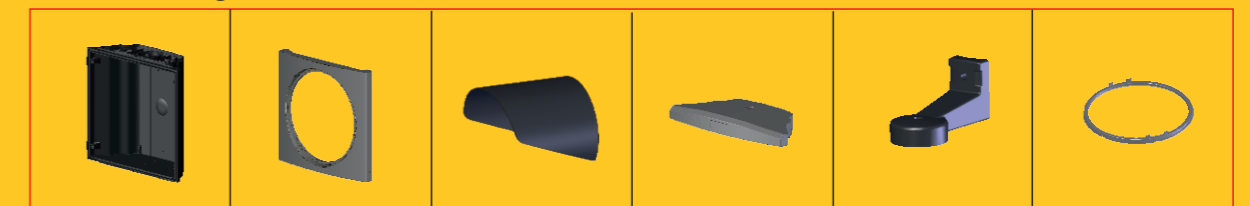

Code 2010 2012 2014 2016 2018 2020

## 100 mm Signalization



Code 1010